

Uniclass	EPIC
L411:P43	D11:X421
CI/SfB	
(31-5) Xh4	



**comar**  
ARCHITECTURAL ALUMINIUM SYSTEMS

## comar7P.i CD

Comar 7Pi Commercial Door Thermally Broken (P.i) doors,  
offering swing or auto-sliding configurations.  
Options for anti-finger trap stiles and concealed transom closers

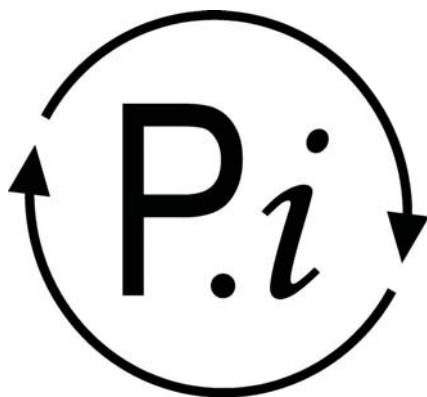

complementing architecture

# comar



## Comar 7P.i. Commercial Swing Doors

Comar Architectural Aluminium Systems are pleased to launch its next generation of commercial swing door sets. By taking the extensive range of solutions from its market leading Comar 7 Door range and coupling this with their trade-marked Comar Pi (polyamide insulation), the new Comar 7Pi Commercial Door offers even lower U-values housed in robust profiles for high traffic areas.

Safety and user friendly solutions are offered in the Comar 7Pi Commercial Door, with aesthetically pleasing round anti-finger trap stiles, that ensures safety for fingers on its hinge stile and thresholds that cater for DDA compliance.

Security concerns are alleviated as the doors have been extensively tested to PAS24, offering compliance with the very latest security specifications. As such, a range of locking options are available which include single or multi-point with Axim flush-bolts.

The Comar 7Pi Swing Doors are available in single or double configurations with options for double action open-in and open-out. The doors can be hung from the market leading range of Axim concealed closers, which offer mechanical back-check with hold or no hold-open options.

Automatic options are catered for with integration into Comar's extensive range of existing framing and auto door beams.

# on-time

## Comar 7P.i. CD with Anti-finger Trap Stile

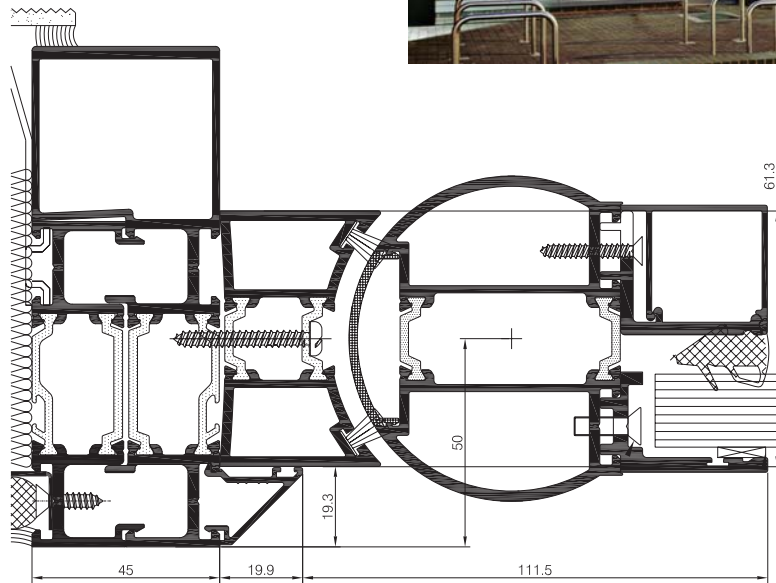

General Arrangement showing Comar 7Pi Commercial Door with anti-finger trap stile

## Comar 7P.i. CD Security Option Sill Detail

### Standards

PAS24	Pass
-------	------

### Size Limitations

	Width	Height	Weight
Single Door	1150mm	2400mm	90Kgs
Double Door	2300mm	2400mm	90Kgs (per door)

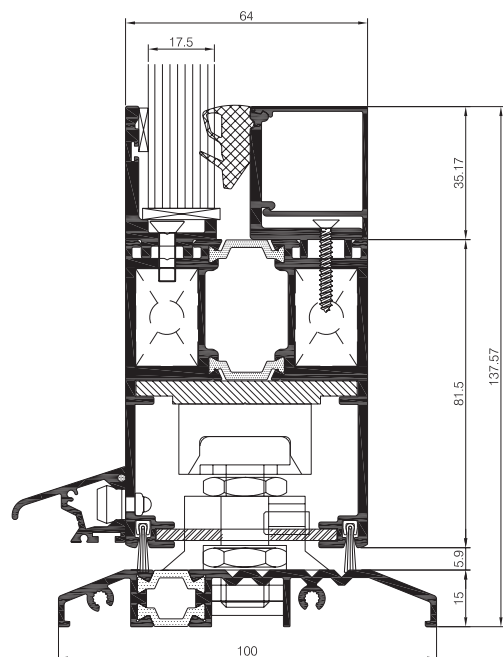

General Arrangement showing Comar 7Pi CD with a low-rise thermally broken sill option

# deliver



Comar 7P.i. CD Head Detail

Comar 7P.i. CD Jamb Detail

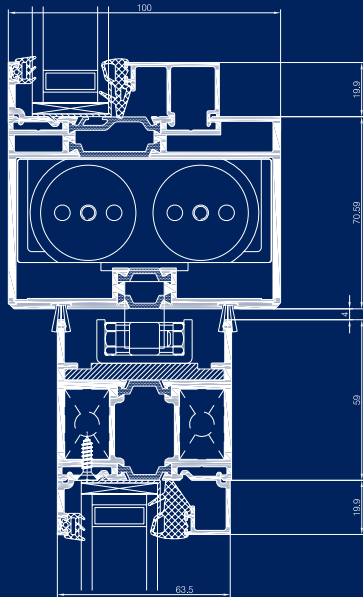

General Arrangement showing Comar 7Pi CD Head Detail with a Concealed Axim Closer

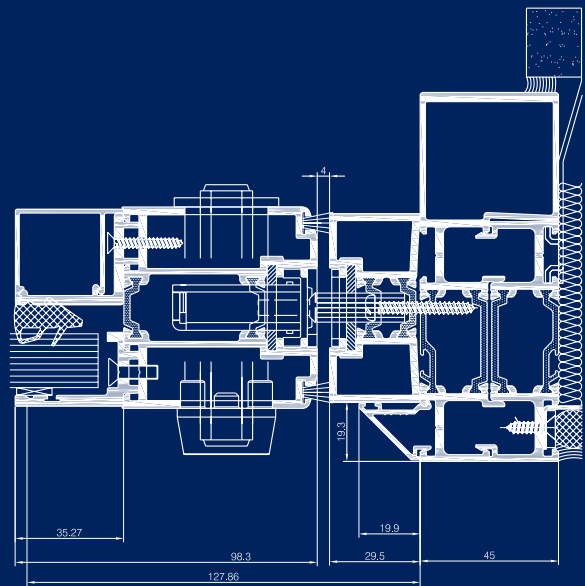

General Arrangement showing Comar 7Pi CD with the Security Jamb Locking Detail

## Comar 7P.i. CD Automatic Door

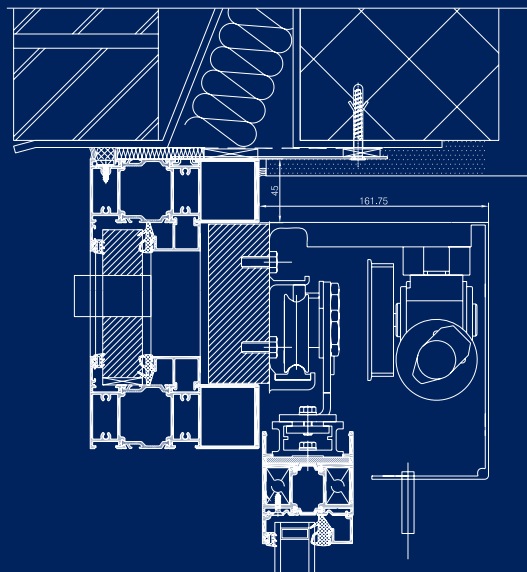

General Arrangement showing Comar 7Pi CD Automatic Door Head Detail



# solution

## Comar 7P.i. CD Double Door Meeting Stiles

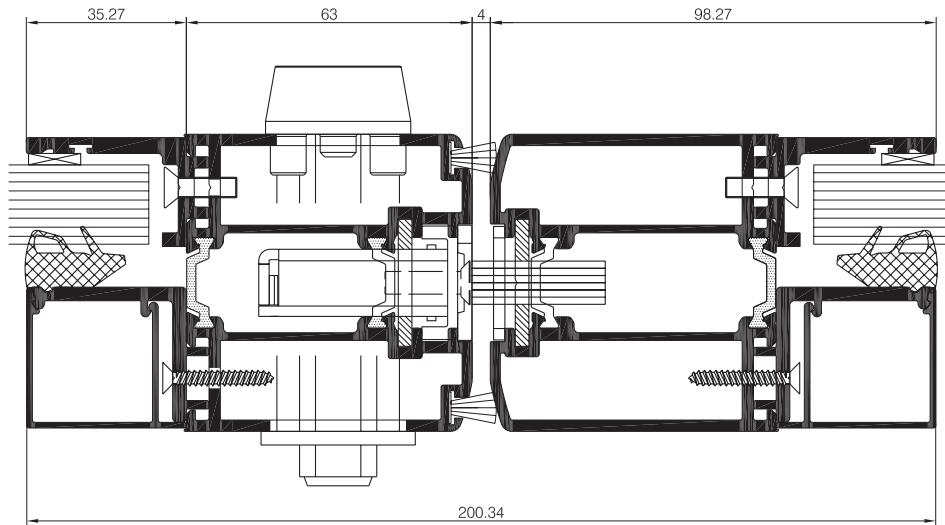

General Arrangement showing Comar 7Pi CD Double Door Meeting Stiles

## Comar 7P.i. CD Midrail Detail

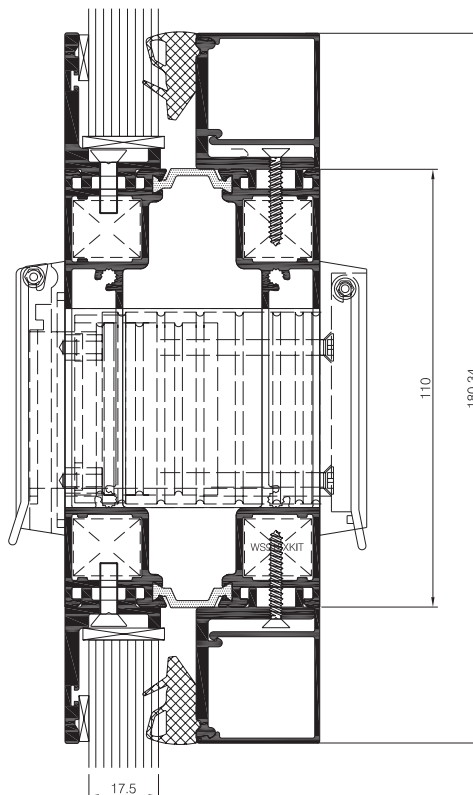

General Arrangement showing Comar 7Pi CD Security Midrail Option with Axim letterplate



## Technical Back-Up

An experienced Sales Team covers the UK while the Technical Department offers an unsurpassed design and installation advice service to designers, specifiers and fabricators. Simply call: +44 (0)20 8685 9685

## For More Information

To find out more about this or any other Comar Architectural Aluminium System, or to obtain your personal copies of the Comar Technical Manuals, call: +44 (0)20 8685 9685 or fax on: +44 (0)20 8646 5096



BSI: ISO 14001



BSI: ISO 9001

### The Parkside Group Ltd

Unit 5, The Willow Centre  
17 Willow Lane, Mitcham  
Surrey CR4 4NX

Tel: +44 (0)20 8685 9685

Fax: +44 (0)20 8646 5096

Email: [sales@parksidegroup.co.uk](mailto:sales@parksidegroup.co.uk)

Web: [www.comar-alu.co.uk](http://www.comar-alu.co.uk)