

Uniclass	EPIC
L411:P43	D11:X421
C1/S1B	
(31.5) Xh4	



**comar**  
ARCHITECTURAL ALUMINIUM SYSTEMS

## comar7P.i ECO

Thermally efficient Polyamide Insulation (P.i) door system

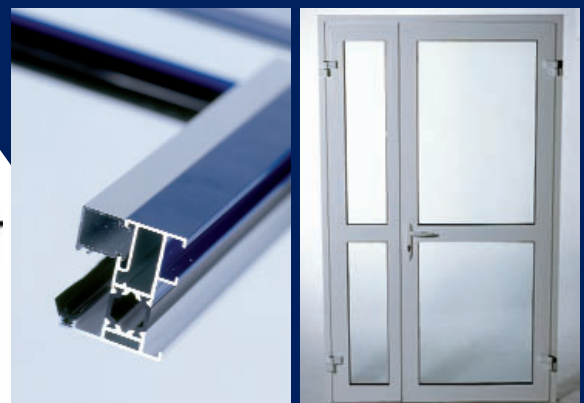

complementing architecture

# comar

## Comar 7P.i. Eco Door System

The Comar 7P.i. ECO door has been designed to provide high performance solutions for today's specification demands. Utilising Comar's trademark P.i. (Polyamide Insulation) thermal break technology, it delivers superior thermal performance with an aesthetic edge. Aesthetics come from its slim 55mm profiles, seamlessly integrating with the Comar 5P.i. ECO casement window system.

Offering single or double doors that can open in or open out, the door is ideally suited to light-commercial, residential or social housing projects. Comar 7P.i. ECO has been tested to PAS 23 (General Performance for Door Assemblies) which ensures the door performs well against the rigours of the British weather, reducing draughts and providing excellent weather-proofing. This ensures that, even in the most extreme locations, the Comar 7P.i. ECO doors maintain their high performance.

Security concerns are alleviated with the Comar 7P.i. ECO door exceeding the requirements of PAS 24 (Enhanced Security Performance for Door Assemblies) with its secured by design multi-point locking system and key cylinder that is both anti-bump and anti-snap, ensuring the highest levels of reassurance against intruder attack.

Comar 7P.i. ECO comes with various threshold options, such as rebated for weather performance or low-rise for compliance with the Disability Discrimination Act (D.D.A).



# perform

For smooth, continuous operation, the hinges are clampable and adjustable. This means that the door can be altered to cater for building tolerances and long term maintenance requirements.

The handle options can be lever-lever or, for additional security, push pad-lever. If required, the handles can be in project specific finishes.

## AXIM Hardware

The AXIM range of surface mounted closers can be fitted to the door. The Comar 7P.i. ECO door has a mid-rail option to cater for AXIM letter plates or, where a panel is specified, to the bottom of the door.

## Size Limitations

	Width	Height	Weight Limitation
Single Door	1100mm	2400mm	90Kgs
Double Door	2200mm	2400mm	90Kgs Per leaf

## Thermal Performance

	Open In	Open Out
Single Door CEN Door Size	2.00W/m2k	2.00W/m2k
Double Door CEN Door Size	1.95W/m2k	1.95W/m2k

## Standards

PAS 23	Pass
PAS 24	Pass

## Combinations

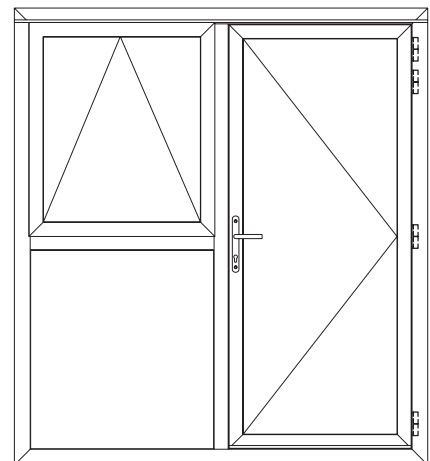
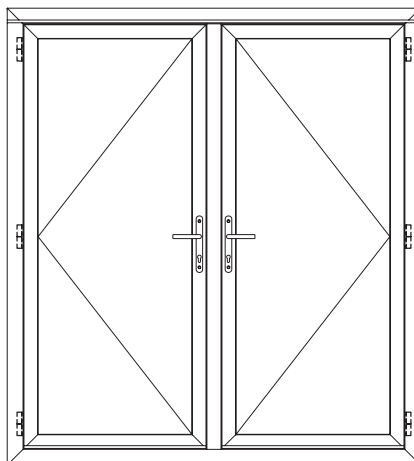
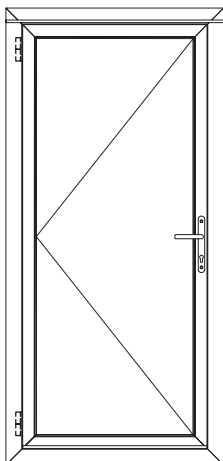

## Comar 7P.i. ECO Door Coupling Detail to Comar 5P.i. ECO Window

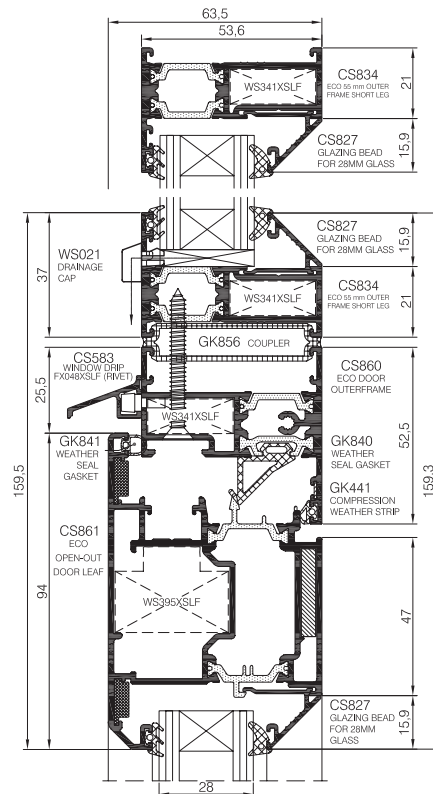

Comar 7P.i. ECO Door, coupling head detail, open-out, internally beaded to Comar 5P.i. ECO window as a fan light

# on-time



## Comar 5P.i. ECO & Comar 7P.i. ECO Integration

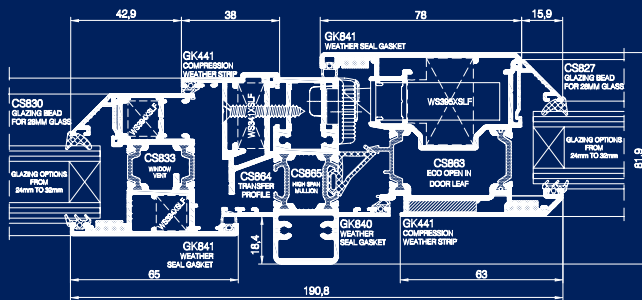

General Arrangement, showing Comar 7P.i. ECO coupling jamb with Comar 5P.i. ECO casement open light

## Comar 7P.i. ECO Double Doors Open-out

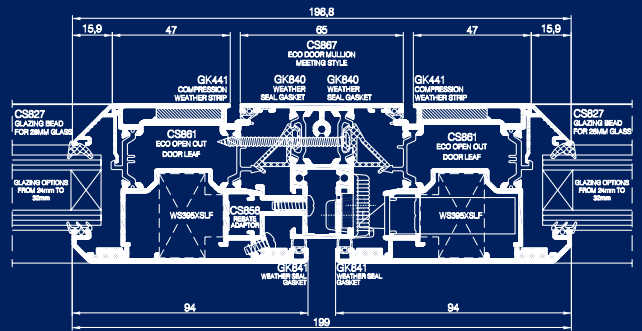

General Arrangement showing Comar 7P.i. ECO double doors open out, meeting stile

## Comar 7P.i. ECO Coupling Detail with CS843

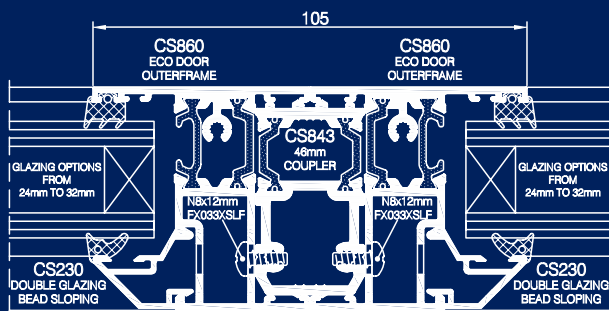

General Arrangement Showing Coupling Detail with CS843, creating slim sight lines and high deflection loads

## Comar 7P.i. ECO Door Mid-rail Detail

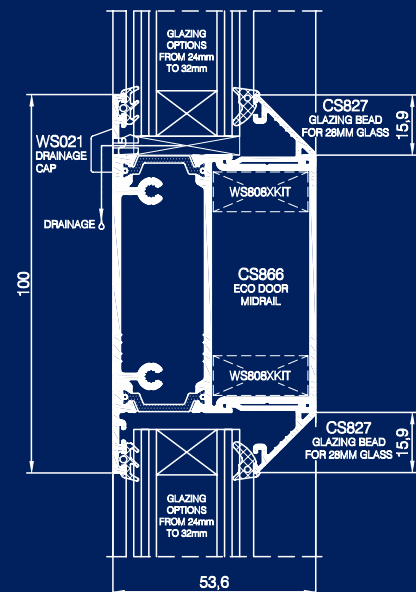

Comar 7P.i. ECO Door mid-rail detail with optional AXIM letterplate

# on-time

Comar 7P.i. ECO Door 55mm, Open-out

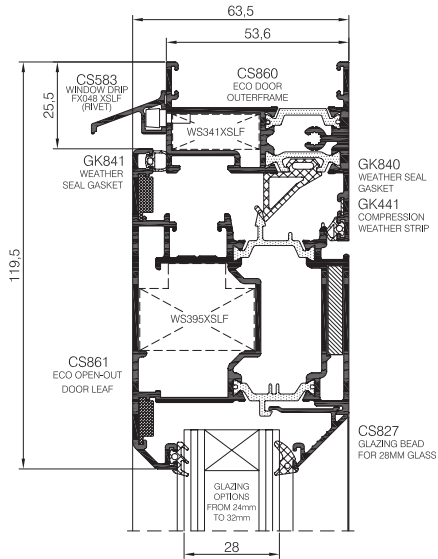

General arrangement showing Comar 7P.i. ECO open-out head detail

Comar 7P.i. ECO Door 55mm Open-in

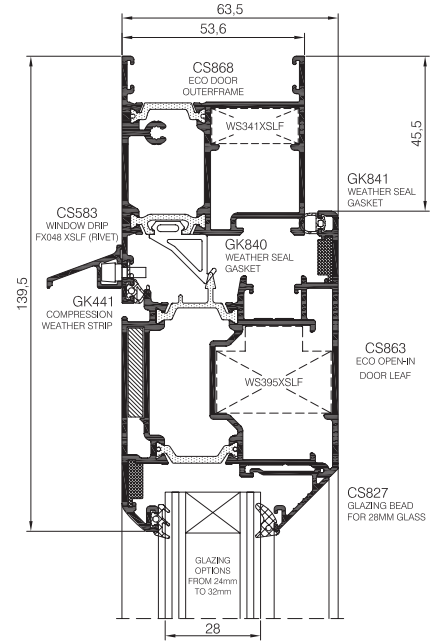

General arrangement showing Comar 7P.i. ECO head detail

Comar 7P.i. ECO 55mm Door Open-out

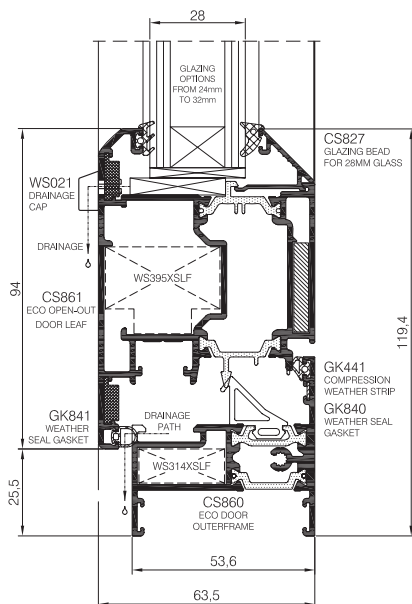

General arrangement showing Comar 7P.i. ECO open-out threshold detail

Comar 7P.i. ECO 55mm Door Open-in

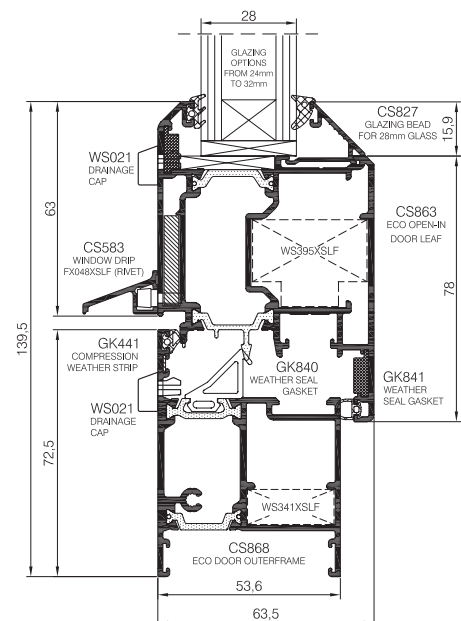

General arrangement showing Comar 7P.i. ECO open-in threshold detail

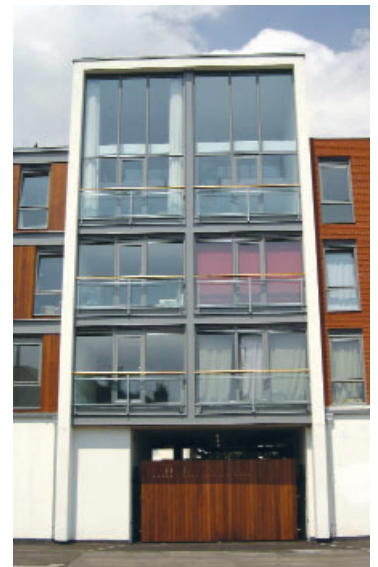

## **Technical Back-Up**

An experienced Sales Team covers the UK while the Technical Department offers an unsurpassed design and installation advice service to designers, specifiers and fabricators. Simply call: +44 (0)20 8685 9685

## **For More Information**

To find out more about this or any other Comar Architectural Aluminium System, or to obtain your personal copies of the Comar Technical Manuals, call: +44 (0)20 8685 9685 or fax on: +44 (0)20 8646 5096

### **The Parkside Group Ltd**

Unit 5, The Willow Centre  
17 Willow Lane, Mitcham  
Surrey CR4 4NX

Tel: +44 (0)20 8685 9685

Fax: +44 (0)20 8646 5096

Email: [sales@parksidegroup.co.uk](mailto:sales@parksidegroup.co.uk)

Web: [www.comar-alu.co.uk](http://www.comar-alu.co.uk)